

QUICKSILVER®



www.marinepower.com
2005

PORTABLE AFFORDABLE FUN

Enjoy portable, affordable fun on the water with a splendid new Quicksilver® inflatable. This is go-anywhere fun for the whole family. Lightweight portability, quick to set up, easy to operate, fitted with the best outboard power around and reassuringly safe and stable. Boats packed with boating benefits.



Looking for a RIB?

Ask your dealer about Valiant Rigid Inflatable Boats.



Quicksilver is one of the largest inflatable boat companies in the world and part of Mercury Marine, global leader in pleasure boat propulsion, parts, accessories and many more things boating. Mercury Marine has been setting the standards for well over 60 years.

Whatever your boating needs, whether you're taking a picnic out on the lake, exploring a new coastline or needing a tender to get ashore, there's a robust, economical Quicksilver for you.

If you're looking for a rigid inflatable, ask your dealer about Valiant® RIBs, designed and built to exacting standards for pleasure and commercial use. Valiant is also part of the Mercury Marine family.

The Boat To Fit Your Lifestyle

SOME QUICKSILVER BENEFITS

- New stainless steel transom eyes on all boats that make your life easier to lift, lock and tow
- New: 270, 310 and 340 models feature a combined oar retainer and rope holder for an elegant and cleaner look. Swimplatform mounted davits are easier to install too
- QuickLift end cones allow you to plane the boat faster. They are especially designed for four-stroke engines
- Tough and longer lasting, Quicksilver inflatables use extra strong European-made fabric
- All AirDeck™, Sport and Heavy-Duty models have an inflatable keel under the floor for better performance
- Sport models have new Euro-style tubes for more space in the boat and easy to upgrade with AirDeck floor
- There are multiple air chambers for reliable buoyancy and extra safety
- Keel protection wear strip helps to protect the fabric against abrasion when beaching
- The floors of the Sport and AirDeck models are easily interchangeable thanks to Quicksilver's unique new transom cleat
- All Quicksilver inflatables are equipped with spray shields to help eliminate backwash and protect you from water thrown up by the propeller
- Larger boats have two seat positions or are pre-equipped to take an optional second seat
- Every boat is backed with a 5-year limited fabric and seam warranty

ROLL-UPS 4-5
200
240

SPORT 6-7
240
270
310
340

AIRDECK 8-9
240
270
310
340

HEAVY-DUTY 10-11
380
430



QUICKSILVER®
INFLATABLES

www.marinepower.com



ROLL-UPS

ROLL OUT THE ENJOYMENT

These economical lightweight dinghies are perfect for quick ship-to-shore trips. And Quicksilver Roll-Up models are easy to set up and pack up.

They're compact for storage on your boat or back at home. With slatted floorboards these tough little inflatables make excellent tenders and there is a new, improved rowing position. **Perfect For Short Trips Or The Long Haul.**



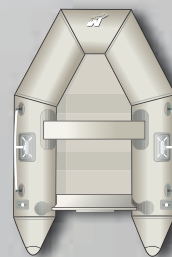

200 RU
This dinghy weighs only 15.8 kgs.

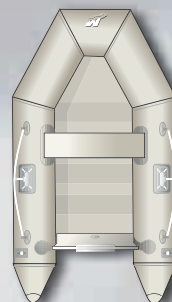

240 RU
Will take up to 5HP of outboard power

Roll-Ups Specifications	200	240
MAX PERSONS	2	3
MAX HP	4	5
MAX ENGINE WEIGHT (KG)	25	25
WEIGHT INCL. PUMP, OARS & REPAIR KIT (KG)	15.8	18.4

Full specifications on page 15

- Superbly tough to carry people and gear with ease and there is a new, ergonomically designed rowing position
- Safe and sure with two separate internal air chambers
- Plywood transom with engine pad and plate for your outboard and standard transom cap to avoid knocks when rigging the boat
- Double action hand pump and seat are standard equipment
- Includes carrying bag and repair kit
- Every boat is backed with a 5-year limited fabric and seam warranty



QUICKSILVER®
INFLATABLES

www.marinepower.com

SPORT MODELS

ALL AROUND FAMILY BOATING

Quicksilver Sport inflatables with their new Euro-style tubes for greater floor space are big enough to haul lots of people and gear yet compact and easy to carry. This is economical boating at its best.

Their low centre of gravity makes them ideal craft for all-around family boating. From short trips to on-water adventures, you can always rely on Quicksilver inflatables to provide fun on the water.

More Of Everything.



Sport Specifications	240	270	310	340
MAX PERSONS	3	4	4	5
MAX HP	6	10	15	15
MAX ENGINE WEIGHT (KG)	25	40	50	50
WEIGHT INCL. PUMP, OARS & REPAIR KIT (KG)	39.4	44.3	48.5	53.7

Full specifications on page 15

- Euro-style tubes for more space in the boat
- Spray shield helps keep passengers and gear dry
- Strong wooden floor will stand up to years of use
- The security of 4 separate internal air chambers (3 + keel)
- Double action hand pump is just one of the many standard accessories
- Best quality Halkey-Roberts valves
- Every boat is backed with a 5-year limited fabric and seam warranty

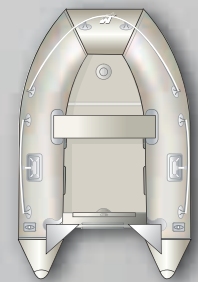

240 S

All-purpose boating from Quicksilver

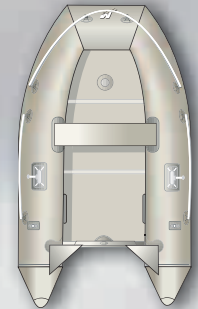

270 S

The engine bracket is cast aluminium



310 S

This boat has stainless steel towing rings, as on all models

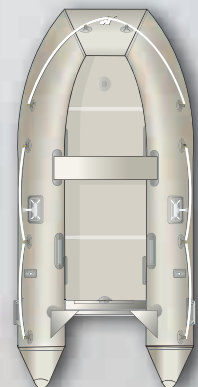

340 S

Biggest in the range, takes up to 5 people



QUICKSILVER®
INFLATABLES

www.marinepower.com

AIRDECKS

THE ORIGINAL AIR ON WATER

With attractive European styling, these deluxe Quicksilver tenders weigh in around 25% lighter than comparable wooden floor inflatables. There are no loose parts to assemble and AirDecks are an absolute breeze to carry.

Now available in four sizes and two colour schemes, these versatile boats replace traditional wooden floorboards with a high-pressure inflatable floor. They are incredibly light and roomy. **Lightening Your Load.**



AirDeck Specifications	240	270	310	340
MAX PERSONS	3	4	4	5
MAX HP	6	10	15	15
MAX ENGINE WEIGHT (KG)	25	40	50	50
WEIGHT INCL. PUMP, OARS & REPAIR KIT (KG)	31.8	33.9	36.3	39.1

Full specifications on page 15

- Great value and longer lasting through its heavy-duty fabric and tight-weave nonstretch polyester core, as used on all Quicksilver inflatable boats
- Attractive European styling brings a distinctive look
- Designed for more interior room for you and your passengers
- The convenience of a one-way drain valve with plug (available on complete Quicksilver inflatable range)
- Just in case, a repair kit in waterproof container comes as standard (available on complete Quicksilver inflatable range)
- Every boat is backed with a 5-year limited fabric and seam warranty
- Classic and elegant look for the 270 GA and 340 GA: soil resistant grey tubes with blue highlights

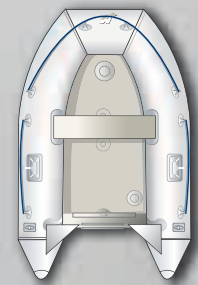

240 EA
Extra room due to European styling

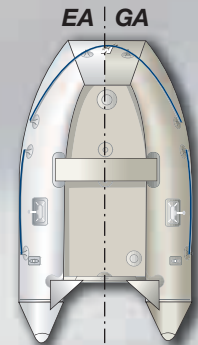

270 EA/GA
Lightweight and comfortable



310 EA
Near-instant fun on the water

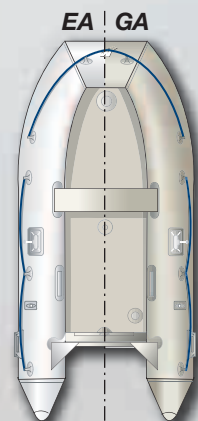

340 EA/GA
Stable and manoeuvrable



QUICKSILVER
INFLATABLES

www.marinepower.com



HEAVY-DUTY

WORKHORSES FOR THE WATER

Quicksilver's heavy-duty inflatables, the rugged 380 HD and 430 HD, are ideal for boating applications where a little more space and strength are required.

These boats are perfect for scuba diving and rescue teams, for instance, carrying up to eight people. And divers love the soft tubes and low freeboard that make them easy to roll off and reboard, even in rough water. Bright and easy to see, Quicksilver heavy-duty inflatables are ready for hard work and adventure.

NEW! For the most demanding applications, the XS-Duty™ 380 HD and 430 HD models are now available with an aluminium/composite floorboard systems. Tougher than ever and ready to take a beating in almost any condition. **For Whatever You Need.**

Heavy-Duty Specifications	380	430
MAX PERSONS	6	8
MAX HP	25	30
MAX ENGINE WEIGHT (KG)	60	80
WEIGHT INCL. PUMP, OARS & REPAIR KIT (KG)	82.1	98.6

Full specifications on page 15

- Transoms are protected by a heavy duty exterior laminate making them durable and long lasting
- Tough and abrasion resistant with reinforced heavy-duty fabric and additional double-layer, non skid, wear pads
- Further strength from heavy duty aluminium-framed floorboards
- On-board gear can be kept secure using internal stainless steel D-rings plus tie-downs intergrated in to the floorboards
- Ease of transport and launching aided by seven external carrying handles and hogging strips all around
- Extra visibility through highly noticeable red fabric
- Every boat is backed with a 5-year limited fabric and seam warranty
- The 430 HD can now take up to 30HP Mercury or Mariner, 429cc

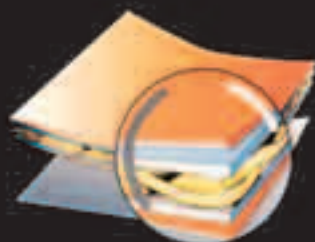

Valmex® ensures maximum durability, resists to high temperature, moisture and dirt. Your Quicksilver will last longer!

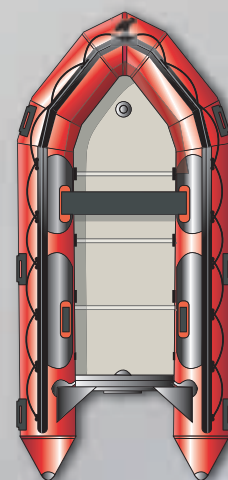

380 HD

These boats have specially reinforced heavy-duty fabric, as well as double-layer, non skid, wear pads

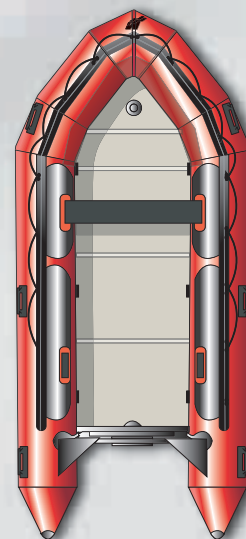

430 HD

You can fit up to 30HP on the 430 HD

QUICKSILVER®
INFLATABLES

www.marinepower.com

STORAGE & SEATING



Bow Dodger / Bag Kit

Easy to fit, water-repellant Cordura® nylon bag closes with a non-corroding nylon zipper and hangs under the dodger.

62-808646A2



Underseat Storage Bag

Durable, colour co-ordinated storage bag made from Cordura nylon. Fits all Quicksilver inflatables except 200 and 240 models.

62-808647T



Igloo Ice Chests & Refrigerators

Igloo products are designed to provide worry-free protection for food and beverages on your boat.

See *Boating Accessories Guide* for full offering and part numbers.



Adjustable Storage Seat With Cushion

The padded storage seat adjusts easily for use on 240 to 340 models. Easy to install and remove, size 25cm high x 46cm deep x 69-84cm wide.

62-809541A1



Inflatable Thwart Seat

This grey inflatable thwart seat in a variety of sizes fits most Quicksilver inflatables.

62-811816 (Roll-Up, Sport, AirDeck™ 230 to 260)
62-811905T 1 (380 HD)

White Vinyl Bench Seat With Attaching Hardware

Fold-back cushion seat, 66cm wide, with aluminium base and attaching hardware. Fits Quicksilver 270 and larger Sport and Heavy-Duty models.

62-827658A1



White Vinyl Seat Cushion

This foam-filled vinyl cushion fits the rowing seat. It includes six snap-on attachments.

62-809773 (30" - for 230, 240 & 260)
62-809773 1 (34" - for 270 - 340)
62-809773 2 (40" - for 380)
62-809773 3 (44" - for 430)

AIR PUMPS



Bravo Automatic Inflator & Deflator

Works off a car battery to provide you with up to 300mb of pressure. Auto shutoff prevents over-pressure. Supplied complete with universal adaptors, including valve and battery connectors.

62-803905 (12v) 62-809685 4 (adapter set)

Features an automatic shutoff when pressure reaches 200 mb, with manual override for additional pressure if needed.

62-877364 (220v) 62-809685 4 (adapter set)



QS Double Action Air Pump

An easy-to-use, hand pump that's much faster than a standard foot pump. Either use single action, which pumps when pushing, or double action, which pumps when pushing and pulling. QS, HR and Valiant adaptors and pressure gauge are also included.

62-889345Q01
62-889347 (3 adapter set)



Valve Fill Adapters

Halkey-Roberts

62-809685 fits old-style valve 19 mm
62-809685 1 fits old-style valve 14 mm
62-809685 2 fits new-style valve 19 mm
62-809685 3 universal

Quicksilver

62-859044A1 fits 200RU & 240RU (2001 & 2002 models)

COVERS

Boat Cover

Rip-stop nylon cover with UV inhibitors and water repellent ZEPEL® finish to protect your inflatable from the elements. Also fits over the attached outboard.

62-8234421 (200, 230) 62-880860 (340)
62-811350 (240, 260, 270) 62-811837 (380)
62-811351 (300, 310, 330) 62-809172 (430)

FUEL TANK



Fuel Tank Hold-Down Kit

Made with polypropylene strapping for superior strength. Quick-release buckles simplify replacement of the tank.

62-809610

ENGINE



Spray Deflector

Helps prevent spray from entering your boat. Easy to install.

62-809728A1



Engine Cover

This cover is the best way to protect your engine during storage or to protect the cowl when your boat is moored.

See *Boating Accessories Guide* for full offering and part numbers.



Easy Lift Motortote

Fitting outboard engines up to 15HP (11.2kW) and able to be left in place permanently, this is a secure handle for raising and lowering the engine.
62-809630



Combination Bow Light

Battery-operated Attwood bow light with attachment base, designed for inflatables or other surfaces where screws cannot be used.
67-808766

REPAIR ACCESSORIES



Hydrofoil Stabiliser Kit

For Mercury and Mariner outboards 6-25HP (4.5-18.7kW) and designed to enhance performance by quicker planing and better acceleration.
62-808657A1

MOORING



Inflatable Boat Anchor

Designed specifically for safe and easy use with inflatable boats. A mushroom anchor in a choice of three weights, coated in black plastisol.

- 67-831431 (3.6 kg)
- 67-831432 (4.5 kg)
- 67-831434 (6.8 kg)



Smart Tabs

Smart tabs are completely automatic requiring no operator adjustment while underway. The nitrogen Gas Actuator provides LIFT at the stern of the boat by holding the trim plate down during acceleration. The amount of LIFT is determined by the actuator load rating and the trim plate adjustment, which is done at the time of installation.

See *Boating Accessories Guide* for full offering and part numbers.

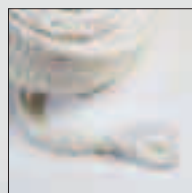

Anchor Line

Three-strand polyester with thimble (40 m).

- 67-882918 (Ø 10 mm)
- 67-882919 (Ø 12 mm)

Attachments

All attachments of your boat are available separately and can be fitted to meet your personal needs.

See *Accessories Guide* for full offering & partnumbers.

LIGHTING

Clamp-On Stern Light

Attwood® 61cm high all-around light for inflatables and other small craft which do not have permanently mounted navigation lights.

67-808768



TRAILERING



Dinghy Dolly Launching Wheels

Wheels roll easily over firm surfaces and tuck out of the way once the boat is out of the water. For all Quicksilver inflatables.

62-808606A1

M.E.K. Patching Solvent & Cleaner

For cleaning inflatable tubes before using 2-part glue.

92-818702

PVC Repair Kit

Contains two grey fabric patches and one tube of cement in a waterproof plastic canister.

92-811314-2

Plastic Valve Key

62-896317



2-Part Glue

Used to attach handles and larger accessories to the boat tubes. For PVC and Hypalon fabrics.

- 92-818651A3 (118 ml)
- 92-818651A4 (236 ml)
- 92-818651A2 (946 ml)



1-Part PVC Glue

Used to attach small accessories and for minor repairs.

92-808648

Crossbar Steering Kit & Attaching Hardware

Adjustable width, aluminium tube crossbar steering unit which attaches to the lacing cuffs on top of the tube. Includes crossbar frame, 33 cm steering wheel, bezel, rack helm, steering cable and attaching hardware. (It does not include control box, shift and throttle cables or attaching kits for the engine).

- 62-827640A8 (2.4 m)
- 62-827640A11 (3.4 m)

Star Brite

Star Brite Inflatable Boat & Fender Cleaner/Protector
67-8298186



AquaSeal Combo Pack

The combination of AquaSeal and CotoI-240 means repairs will be tack-free in around 15 minutes and dry in about two hours.

92-809627

Lacing Cuffs

Lacing cuffs (you need to order two), 46 cm, for use with crossbar steering.

62-809107 (black)



STEERING

SeamGrip™ 1-oz Tube

Excellent for minor seam or small puncture repairs. Seals and repairs in one application and dries overnight.

92-809628



WATERSPORT



Aquaseal® 1-oz Tube

Thicker than SeamGrip, it repairs small tears and cuts in fabrics such as PVC, Hypalon and more. Dries overnight.

92-809626

Pedestal Rotary Steering Kit

Floor mounted and made of stainless steel tube construction. The kit includes pedestal frame, 33 cm steering wheel, bezel, rotary helm, steering cable and attaching hardware. (It does not include control box, shift and throttle cables, or attaching kits for the engine).

- 62-827659A6 (1.8 m)
- 62-827659A10 (3.0 m)
- 62-827659A11 (3.4 m)



Water skis

High quality, durable skis, wakeboard and tube, including "wide body" water skis for low horsepower use, offering you new ways to enjoy yourself.

See *Boating Accessories Guide* for full offering and part numbers.



SeamGrip Combo Pack

Seams will seal in two hours using the combination of SeamGrip and Seam Excel. It is tack-free in around 15 minutes, for fast repairs.

92-809627



Steering Wheel

Soft-grip 33cm polyurethane steering wheel.

62-827667

Ski Vests & Life Jackets

Vest with closed sides, CE approved 50N CE 95 EN 393, coated nylon shell and soft foam. CE-approved 100N life jacket, CE EN 395.

See *Boating Accessories Guide* for full offering and part numbers.

COLOUR	MODEL	CE DESIGN CATEGORY	PART NUMBER	BAGGED DIMENSIONS (cm)	MAX LOAD (kg)	MAX HP	MAX ENGINE WEIGHT (kg)	MAX PERSONS	NUMBER OF AIR CHAMBERS	 WEIGHT INCLUDING PUMP, OARS & REPAIR KIT			
						 <i>All short shaft.</i>				a (cm)	b (cm)	c (cm)	d (kg)
ROLL-UP	200 Roll-Up	D	AA200004N	99 x 56 x 38	230	4	25	2	2	200	130	34	15.8
	240 Roll-Up	D	AA240002N	99 x 56 x 38	315	5	25	3	2	240	134	36	18.4
SPORT	240 Sport	D	AA240004N	102 x 56 x 30	390	6	25	3	3 + keel	240	152	40	39.4
	270 Sport	D	AA270005N	102 x 56 x 35	450	10	40	4	3 + keel	270	152	40	44.3
	310 Sport	C	AA310003N	102 x 56 x 40	520	15	50	4	3 + keel	310	152	40	48.5
	340 Sport	C	AA340003N	102 x 56 x 46	570	15	50	5	3 + keel	340	152	40	53.7
AIRDECK	240 AirDeck	D	AA240006N	102 x 56 x 30	480	6	25	3	3 + keel + floor	240	152	40	31.8
	270 AirDeck	D	AA270007N	102 x 56 x 35	545	10	40	4	3 + keel + floor	270	152	40	33.9
	310 AirDeck	C	AA310005N	102 x 56 x 40	635	15	50	4	3 + keel + floor	310	152	40	36.3
	340 AirDeck	C	AA340005N	102 x 56 x 46	705	15	50	5	3 + keel + floor	340	152	40	39.1
AIRDECK	270 AirDeck	D	AA270008N	102 x 56 x 35	545	10	40	4	3 + keel + floor	270	152	40	33.9
	340 AirDeck	C	AA340006N	102 x 56 x 46	705	15	50	5	3 + keel + floor	340	152	40	39.1
HEAVY-DUTY	380 Heavy-Duty	C	AA380003N	132 x 71 x 28	760	25	60	6	3 + keel	380	172	44	82.1
	430 Heavy-Duty	C	AA430004N	135 x 74 x 32	980	30	80	8	3 + keel	430	186	47	98.6

NOTE: Due to our constant efforts to offer the finest products available, Quicksilver inflatables reserves the right to change specifications without notice.
WARRANTY: Mercury Marine backs every 2005 Quicksilver inflatables with a full five-year limited warranty on fabric and air holding seams.

For Every Kind Of Boating Fun

Quicksilver also offers a wide range of high quality fibreglass-hulled boats, from runabouts to fishing craft to sportsboats to cruisers.

Or choose one of Quicksilver's aluminium boats. They are lightweight, sturdy and long-lasting.

The Very Best Outboard Power

The perfect power for every Quicksilver inflatable is a reliable Mercury or Mariner outboard. Every Quicksilver boat dealer is fully qualified and equipped to maintain your Mercury or Mariner engine in tip-top condition at all times.



10 REASONS TO CHOOSE A QUICKSILVER INFLATABLE

1 QuickLift

QuickLift end cones help get you on plane faster and there is less chance of water coming into the boat when coming off plane. You can also fit a bigger engine if you wish.

2 Stronger Fabric

The fabric used to build Quicksilver's foldable boats is up to 25% stronger than that used by some other manufacturers. It makes your Quicksilver tougher and longer lasting.

6 Fold-down Row Locks

The row locks allow oars to be stored on the outside of the tubes for a lower profile, leaving more open room on top of the tube.

7 Proven Design

Quicksilver boats designs have evolved down the years to today's proven range. They have accumulated over 19 million hours of experience on the water.

8 T-Type Storage Bag

When it is time to put your boat away you will find that Quicksilver's T-Type storage bag is much easier to use than a zipper bag.

9 Wider Choice

Whether you are looking for a lightweight tender or offshore thrills, Quicksilver has a boat for you. From Roll-ups to AirDecks to Sport models to Heavy-Duty Quicksilver will have what you need.

10 Five-Year Warranty

Quicksilver backs all of its boats with a 5-year limited fabric and seam warranty. Quicksilver inflatables are products of Mercury Marine, the world's largest boat engines manufacturer. Sister boat brands include Aquador, Arvor, Askeladden, Baja, Bayliner, Bella,

Bermuda, Boston Whaler, Flipper, Hatteras, Maxum, Örnvik,

Princecraft, Savage, Sealine, Sea Ray, Uttern and Valiant, all from the world's largest pleasure boat builder. With a heritage such as this, it's natural that Quicksilver stands behind every boat that it sells



3 Accessories

All Quicksilver inflatables come standard with the accessories you need to get started on the water. You receive an inflation pump, rowing seat, repair kit, oars and paddles, reinforcing pad for the engine, stainless steel towing eyes, bow handle and a storage bag.

4 Inflatable Keel

All Quicksilver AirDeck, Sport and Heavy-Duty models have an inflatable keel under the floor for better performance than competitors' flat-bottom boats.

5 Quality Assurance

Quicksilver foldable boats are built in a factory with ISO 9002 certification. This is your assurance of a quality product built consistently to exacting standards.



PUT SAFETY FIRST

Remember, boats float. You don't.
Wear a life jacket at all times.

QUICKSILVER®



Marine Power Europe Inc
is ISO 9001:2000 certified



All Quicksilver foldable boats are
ISO 9002 accredited.

Quicksilver is part of the family

BRUNSWICK

www.marinepower.com

© M.P.E. 2004 PPH GB PRINTED IN BELGIUM 90-822489-05

Mercury Marine continuously explores means to improve the products it designs, manufactures and distributes. Changes to the specifications of its engines, boats and accessories are ongoing. Every effort is made to produce sales and service literature which is current. This brochure should not be regarded as a precise guide to the latest specifications. This brochure is also not an offer for sales of any particular engine, boat, or accessory. Distributors and dealers are not agents of Mercury Marine and they have no authority to bind Mercury Marine by any express undertaking or representation, including but not limited to representations of a product, sales, applications, or service nature.